

MALON D MIMMS CO
 85-A MILL ST.
 ROSWELL, GA 30075
 770-518-1100

SPALDING GREEN SHOPPING CENTER
 SUITE D-2
 6305 SPALDING DRIVE
 NORCROSS, GA 30092

SPACE PLAN

DRAWN NORADRISSON
CHECKED
DATE 05/29/2009
SCALE AS SHOWN
JOB NO. MIMMS0000
SHEET

A-1

1 OF SHEETS 1

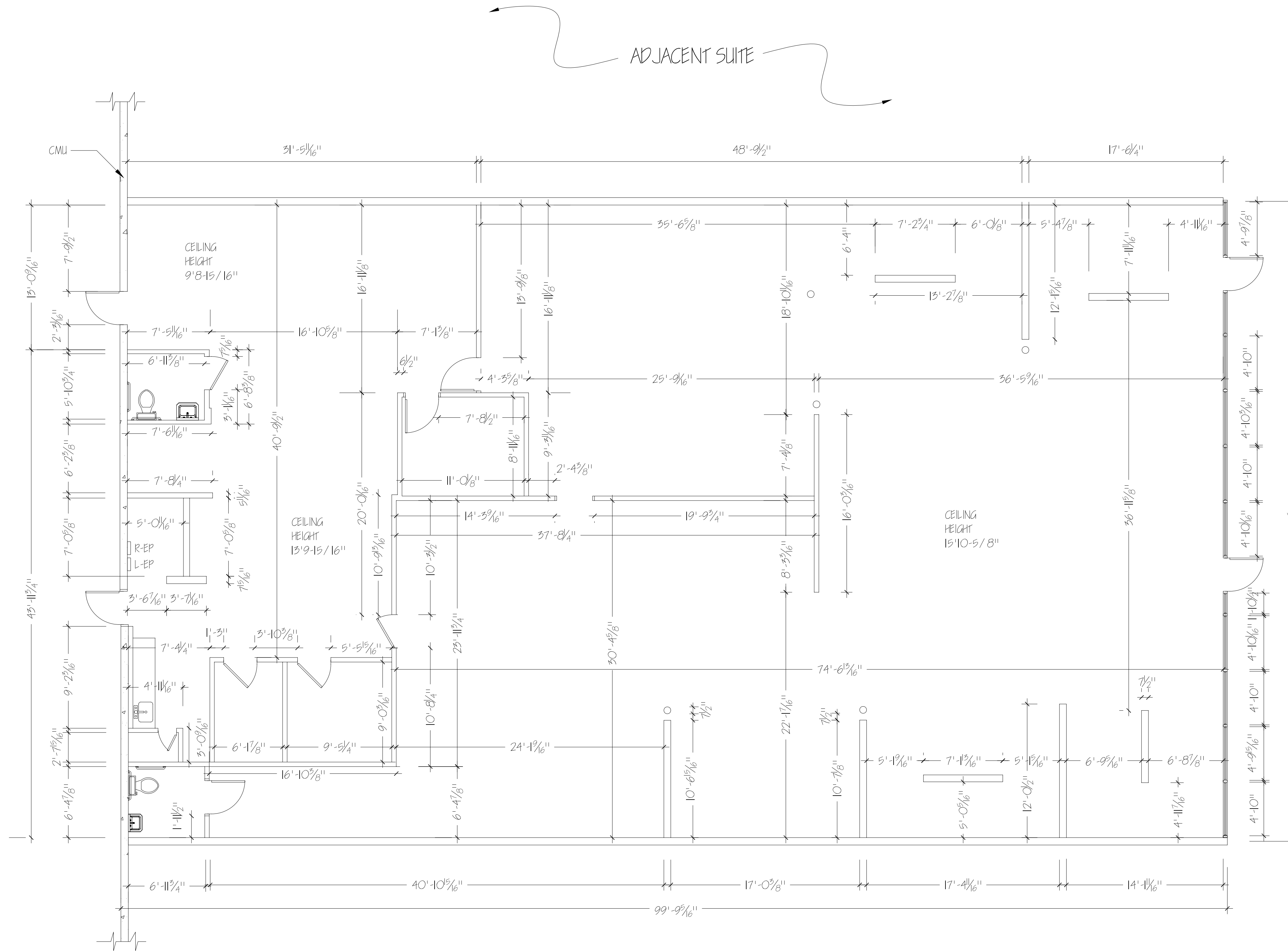

- NOTES:
- 1) ALL DOORS 3'-0" UNLESS OTHERWISE NOTED.
 - 2) DIMENSIONS ARE FOR INTERIOR REFERENCE ONLY, AND DO NOT REFLECT TOTAL SUITE SQUARE FOOTAGE.
 - 3) ELECTRIC PANEL INFORMATION:
 SEIMENS-
 LEFT PANEL- CAT# CDP-7 208Y/120 400 AMPS
 8 SERIES 3 PHASE 4 WIRE
 RIGHT PANEL- CAT # G304ML3200 TYPE I
 200 AMPS 208Y/120VOLTS AC PHASE 3 4 WIRE
 120/240 VOLTS AC 3 PHASE 3 WIRE